

乳神

辺境の王女編



DOJIN
R18
成人向け
18歳未満の
購入・閲覧禁止

THIS IDEOLOGY IS PARTICULARLY PREVALENT AMONG THE NOBILITY, WHO CLAIM TO BE DESCENDANTS OF ASTO. BECAUSE OF THIS CLAIM, BEING INFERIOR IN THE SIZE OF ONE'S BREASTS CAN LEAD TO ONE'S REPUTATION AND DIGNITY AS A ROYAL BEING CALLED INTO QUESTION. THUS, BEING INFERIOR IN SIZE IS ABSOLUTELY IMPERMISSIBLE.

THE REMOTE LAND OF PASTEAL, ACCORDING TO LEGEND, THIS COUNTRY WAS CREATED BY ASTO, A GODDESS OF BOUNTIFUL HARVEST, WHO IS OFTEN DEPICTED AS COVERING THE ENTIRE COUNTRY WITH HER HUGE BREASTS. FOR THIS REASON, THIS COUNTRY HAS A CULTURE IN WHICH THE LARGER ONE'S BREASTS ARE, THE MORE HIGHLY THEY ARE VALUED.



THIS IS BELIEVED TO BE THE RESULT OF VARIOUS PRACTICES AND TECHNIQUES DEVELOPED FOR THE SAKE OF ENLARGING ONE'S BREASTS. UP UNTIL NOW, THE ROYALTY HAS KEPT THESE MATTERS IN STRICT SECRECY, SO THE TRUTH IS UNCERTAIN. HOWEVER, AT THIS TIME I'VE BEEN GRANTED PERMISSION AS AN ANTHROPOLOGIST TO MAKE THE VERY FIRST REPORT ON THESE ROYALS. IT CAN BE SAID THAT THIS IS AN EXCEEDINGLY RARE CASE.

FOR THIS REASON, THE BREASTS OF ROYALTY, PARTICULARLY THOSE OF DIRECT DESCENDANTS, ARE HUGE TO A STARTLING DEGREE. IN THE LONG HISTORY OF THE NOBILITY, THERE IS SAID TO HAVE BEEN AN OWNER OF BREASTS EXCEEDING 10 METERS IN SIZE.



"NOW THEN, PLEASE FOLLOW ME." CONTRARY TO MY EXPECTATIONS OF BEING LED TO THE PALACE, I WAS LED TO A SINGLE, DISCONNECTED HOUSE WITHOUT EVER ENTERING THE PALACE. "PLEASE WAIT HERE." I LOOKED AROUND AND INSPECTED THE ROOM. TO BE FRANK, THIS PLACE FEELS MORE LIKE A COMMONER'S HOME THAN A PLACE WHERE NOBILITY OR ROYALTY MIGHT LIVE. AM I BEING TRICKED?

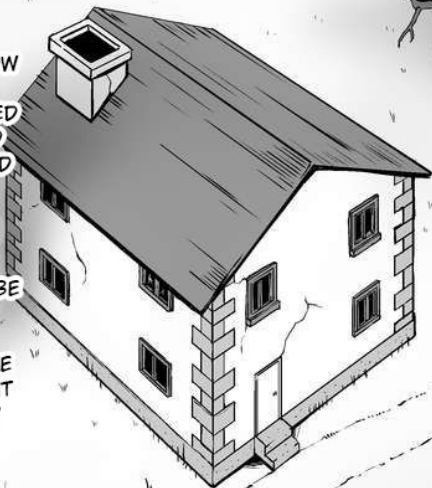

UPON MY ARRIVAL AT THE ROYAL PALACE, A SERVANT OF THE ROYAL FAMILY WAS WAITING FOR ME. "I'VE BEEN EXPECTING YOU. MY NAME IS CLARINE." APPARENTLY, IT SEEMS THAT THIS WOMAN WILL BE SERVING AS MY SUPPORT. AFTER VARIOUS EXPLANATIONS CONCERNING MY REPORT'S COVERAGE, I WAS ASKED TO SIGN A CONSENT AGREEMENT. I BRIEFLY LOOKED OVER AND SIGNED THE DOCUMENTS, AND CLARINE QUICKLY PUT THEM AWAY.



AFTER 10 MINUTES HAD PASSED, CLARINE ARRIVED, ALONG WITH A SWEET LOOKING GIRL. "THIS IS PRINCESS ELEINA. SHE IS PASTEAL'S SECOND PRINCESS." A PRINCESS? I'M BEING ALLOWED TO REPORT ON NOT JUST A RELATIVE, BUT A PRINCESS OF THE ROYAL BLOODLINE? AT FIRST I TOOK IT AS A JOKE, BUT THE GIRL'S CHILDISH FEATURES AND BUILD, IN CONTRAST WITH HER OVERLY DEVELOPED CHEST, WAS AN APPEARANCE EXACTLY MATCHING THE IMAGE OF THE ROYAL BLOODLINE.

HOWEVER, THE CLOTHES OF THE SO-CALLED PRINCESS WERE QUITE THIN LOOKING, AND MUCH LIKE OUR CURRENT LOCATION, GAVE OFF THE FEELING OF A COMMONER. MOREOVER, HER EXCEEDINGLY TIMID DEMEANOR COULDN'T BE SEEN AS VERY REGAL. "PRINCESS ELEINA AND I ARE CURRENTLY LIVING IN THIS PRIVATE RESIDENCE. AS OUR VISITOR, A ROOM FOR YOU HAS ALSO BEEN PREPARED. I'M SURE THAT YOU'RE TIRED AFTER TODAY, SO SHALL WE SAVE BEGINNING WORK ON YOUR REPORT FOR TOMORROW?" WHY WOULD ROYALTY BE LIVING IN SUCH A PLACE? THIS SUSPICION WAS ON THE TIP OF MY TONGUE, BUT THE SERVANT NAMED CLARINE'S INTENSE AIR OF INTIMIDATION STOPPED ME FROM VOICING IT.



MY GAZE SEEMED TO BE MAKING THE PRINCESS EMBARRASSED. AS THE PRINCESS BASHFULLY SQUIRMED AROUND ON THE BED, CLARINE FINISHED UP HER PREPARATION. "WELL THEN, LET'S BEGIN."

WHEN I WOKE UP THE NEXT MORNING, CLARINE LED ME TO THE HOUSE'S BASEMENT. IT WAS AN EXPANSIVE BASEMENT WITH AN UNUSUALLY LARGE REAR EXIT. WHAT THE HELL DO THEY PLAN ON DOING IN THIS HUGE OPEN SPACE? "PRINCESS ELEINA IS A REMARKABLY TALENTED PERSON. THIS AMOUNT OF SPACE IS A NECESSITY." THIS MUCH SPACE IS A NECESSITY? SHE CAN'T BE TALKING ABOUT HER BREASTS, CAN SHE? "HEY OJISAN, WHAT COUNTRY ARE YOU FROM?" PRINCESS ELEINA ASKED. WHILE I WAS CAUGHT UP IN MY THOUGHTS. AS I TALKED ABOUT THE SWEETS I HAD BROUGHT FROM MY HOME COUNTRY, THE PRINCESS'S EXPRESSION BRIGHTENED. "CAN I HAVE SOME OF THOSE SWEETS AFTER THIS IS OVER? HURRAY-!!" IF YOU'RE A PRINCESS, WOULDN'T IT WOULD BE EASY TO GET FOREIGN SWEETS? THERE MUST BE SOME CIRCUMSTANCES I GUESS. "ELEINA-SAMA, WE WILL BEGIN SOON." ONCE CLARINE BEGAN PREPARATION, THE PRINCESS TOOK OFF HER CLOTHES AND LAYED DOWN ON THE BED.



EACH TIME CLARINE FORCEFULLY SQUEEZES THE PRINCESS'S ALREADY MASSIVE BREASTS, THEY BECOME EVEN BIGGER. AND EACH TIME THE PRINCESS'S BREASTS BECOME BIGGER, SO DOES MY PENIS, BECOMING HARDER AND HARDER. IF SUCH A DISPLAY WERE TO BE SEEN, MY REPORT MIGHT BE DISCONTINUED. I BEGAN TO TAKE NOTES IN A WAY THAT THE PRINCESS WOULDN'T NOTICE.

SHE THEN STARTED POURING A MYSTERIOUS MEDICINAL LIQUID ONTO THE PRINCESS'S CLEAVAGE, MASSAGING BOTH BREASTS AND LETTING THE MEDICINE SOAK IN. WHAT KIND OF SUBSTANCE IS THAT? THE PRINCESS'S FACE WAS BECOMING MORE AND MORE FLUSHED. AFTER ABOUT 5 MINUTES HAD PASSED, A CHANGE APPEARED IN THE PRINCESS'S BREASTS. VERY SLOWLY, THE PRINCESS'S BREASTS BEGAN TO SWELL. "AH... HAA... OJISAN... DON'T LOOK SO MUCH." I REALIZED THAT MY GAZE HAD BEEN FIXATED ON THE PRINCESS'S BREASTS THROUGHOUT THAT WHOLE PROCESS...

OVER THESE PAST 30 DAYS, I'VE BEEN ABLE TO GET QUITE CLOSE TO PRINCESS ELEINA. ON TOP OF HER ALREADY FRIENDLY DISPOSITION, WE'VE ALSO SPENT THIS WHOLE MONTH TOGETHER, WHICH IS PROBABLY WHY WE'VE GOTTEN CLOSE. SHE'S ALSO GONE FROM CALLING ME "OJISAN" TO "OJISAMA," SO I CAN TELL THAT THE DISTANCE BETWEEN US HAS SHORTENED. IF THE PRINCESS DISLIKES ME, I WON'T BE ABLE TO CONTINUE MY REPORT. SO WITH THAT IN MIND, I'D SAY THAT THIS IS A GOOD TREND.



SINCE THAT FIRST MASSAGE, 30 DAYS HAVE PASSED. IT SEEMS THAT THE MEDICINE CAUSES A HEAVY BURDEN ON THE BODY, AND CAN'T BE APPLIED AGAIN FOR A WHILE AFTER IT'S BEEN USED. HOWEVER, THAT MEDICINE'S EFFECT CONTINUES FOR SEVERAL MONTHS, NOT AT THE SAME RATE AS THE FIRST DAY, BUT GRADUALLY PROMOTING GROWTH. CERTAINLY, IF YOU COMPARE A PICTURE TAKEN ON THE FIRST DAY AND COMPARE IT TO A CURRENT PICTURE, THE GROWTH IS OBVIOUS. OVER THESE 30 DAYS, SHE'S BEEN GROWING AT A RATE BEYOND COMMON SENSE. CLARINE TOLD ME THAT SHE WILL CONTINUE THE MESSAGES UNTIL SHE REACHES A CONSTANT SIZE.



"MY SISTER AND I... HAVE DIFFERENT FATHERS. SO MY SISTER, MY MOM, AND MY STEP DAD ARE ALL CRUEL TO ME... THEY SAY THINGS LIKE 'IF ONLY YOU WEREN'T ALIVE.'" WHILE LOOKING AT HER SISTER AND SAYING THESE THINGS, PRINCESS ELEINA SEEMED SOMEWHAT LONELY. I DON'T PLAN TO PRY TOO MUCH, BUT IT SEEMS LIKE THERE ARE SOME CIRCUMSTANCES.



THIS DOESN'T HAVE TO DO WITH BREAST GROWTH, BUT RECENTLY I WAS ABLE TO SEE PRINCESS ELEINA'S SISTER. SHE'S OLDER THAN PRINCESS ELEINA, AND HER BREASTS ARE MORE THAN TWICE AS LARGE. ALSO, HER GAUDY APPEARANCE IS EXACTLY LIKE A PRINCESS. UNLIKE PRINCESS ELEINA, I'M SURE THAT SHE'S LIVING LAVISHLY. PRINCESS ELEINA'S COMMONER-ESQUE LIFESTYLE IS ENTIRELY DIFFERENT.

IT APPEARS THAT THIS IS DIFFERENT FROM THE USUAL MASSAGE. "HEY, HEY? WHY ARE YOU BINDING MY HANDS?" WITHOUT REPLYING TO THE PRINCESS'S WORDS, CLARINE BROUGHT OUT SOME KIND OF STRANGE GLASS CONTAINER.

IT'S BEEN 70 DAYS SINCE THE FIRST MASSAGE. JUST AS CLARINE SAID, PRINCESS ELEINA'S BREASTS HAVE GRADUALLY BEEN GETTING BIGGER. "WITH THIS SIZE, YOU SHOULD BE ABLE TO WITHSTAND THE CEREMONY." CEREMONY? IS SHE TALKING ABOUT A NEW ENLARGEMENT METHOD? IN ANY CASE, IT SEEMS CERTAIN THAT WE'RE ENTERING THE NEXT PHASE. "I DON'T LIKE PAINFUL THINGS. IT WON'T HURT WILL IT?" "DON'T WORRY, ELEINA-SAMA. THIS IS SOMETHING THAT ALL ROYAL WOMEN EXPERIENCE." CLARINE CALMLY RESTRAINED THE PRINCESS'S HANDS.

WHAT THE HELL ARE THOSE INSECTS? ARE THEY A WAY OF CAUSING FURTHER BREAST GROWTH? WITH NO HESITATION, CLARINE GRABBED THE INSECTS AND BEGAN PLACING THEM ONE BY ONE ONTO THE PRINCESS'S BREASTS.

I GASPED THE MOMENT I SAW CONTAINER. INSIDE WERE INSECTS THAT I HAD NEVER SEEN BEFORE. "WH, WHAT ARE THOSE..." THE PRINCESS HAD A HUNCH ABOUT WHAT WOULD HAPPEN NEXT, AND HER FACE BECAME PALE.

"O, CLARINE!!! IT HUUUUUUURTS!!!" THE PRINCESS'S SORROWFUL SCREAMS ECHOED THROUGH THE ROOM. "OJISAMA! HELP ME!!! TAKE THEM OUT!!! TAKE THEM OUT!!! I'LL DIE, I'LL REALLY DIE!!!" THE VEINS ON HER BREASTS WERE PUSHED TO THE SURFACE, SEEMING LIKE THEY WOULD BURST AT ANY MOMENT.

THE INSECTS MOVED AROUND AS IF THEY WERE SEARCHING FOR SOMETHING. AND THE MOMENT THEY WERE IN FRONT OF HER NIPPLES... THE INSECTS PRIED OPEN THE PRINCESS'S NIPPLES AND STARTED INVADING THE INSIDES OF HER BREASTS.



"CONGRATULATIONS, ELEINA-SAMA. YOU HAVE BEEN CHOSEN." WHAT DOES SHE MEAN BY "CHOSEN?" ACCORDING TO CLARINE, IN THE CASE THAT ONE DOESN'T HAVE THE APTITUDE, THEY WILL BE TORN APART AND EATEN TO DEATH FROM THE INSIDE OF THEIR BREASTS. SO FAR, THERE HAS NEVER BEEN AN EXAMPLE OF SOMEONE FROM OUTSIDE THE ROYAL FAMILY SUCCEEDING IN THIS. I STARTED THIS INVESTIGATION OUT OF CURIOSITY, BUT IT SEEMS THAT I'VE GOTTEN A GLIMPSE OF A TERRIBLE WORLD BEYOND MY IMAGINATION.

CLARINE HELD DOWN THE STRUGGLING PRINCESS. "ELEINA-SAMA, IT ONLY HURTS AT THE START. ENDURE FOR A BIT LONGER." AND SURE ENOUGH, THE PAINFUL EXPRESSION GRADUALLY STARTED TO DISAPPEAR FROM THE PRINCESS'S FACE. ALONG WITH THIS, I COULD SEE HER FACE BEGINNING TO BLUSH.



IT SEEMS THAT WE WILL BE STARTING OFF WITH SMALL THINGS, AND GRADUALLY, PROGRESSING TO BIGGER THINGS. THIS IS PRINCESS ELEINA'S FIRST TIME BREAST-EATING, SO SHE LOOKS NERVOUS.

"ELEINA-SAMA, UNLIKE THE OTHER DAY'S CEREMONY, THIS WON'T HAVE ANY PAINFUL THINGS. IT'S A VERY GOOD FEELING. IN FACT, YOU MIGHT BECOME ADDICTED." "HUH, IT WON'T HURT?" THE PRINCESS SHOWED SOME RELIEF WHEN SHE HEARD IT WOULDN'T HURT.

IT'S BEEN ONE WEEK SINCE PRINCESS ELEINA SUCCEEDED IN THE CEREMONY, AND SHE'S RECOVERED QUITE A BIT MENTALLY. BY TAKING THE INSECTS INTO HER BREASTS, IT SEEMS THAT THE PRINCESS HAS BECOME ABLE TO SEND NUTRIENTS DIRECTLY INTO HER BREASTS. IT'S A PROCESS CLARINE CALLS "BREAST-EATING." BECAUSE THE GOAL IS TO TAKE IN LIFE FORCE, INSERTING LIVING THINGS IS SAID TO BE THE FUNDAMENTALS. CLARINE SAYS THAT IF THE PRINCESS COMMITS TO BREAST-EATING, SHE WILL BE ABLE TO GROW AT A RATE MANY TIMES FASTER THAN BEFORE.

"I-ITS SCARY, CLARINE." THE PRINCESS WAS SURPRISED BY THE CHANGE IN HER OWN NIPPLES. "PLEASE CALM DOWN, ELEINA-SAMA. IT'S ABOUT TO BEGIN." "O-OK... I'LL TRY MY BEST." CLARINE CALMED THE PRINCESS DOWN.

NOT WANTING TO OVERDO THINGS ON THE FIRST TIME, IT SEEMS THAT WE WILL SEE HOW THINGS GO WITH SOME FISH THAT AREN'T VERY BIG. CLARINE BEGAN TO SLOWLY PUSH FISH INTO THE PRINCESS'S NIPPLES. SURPRISINGLY, THE PRINCESS'S NIPPLES OPENED UP AND STARTED TAKING THE FISH IN.

"HA~!!... HA~!! MORE... I WANT TO EAT MORE!!!" THE PRINCESS WAS BEGGING FOR EVEN MORE "BREAST-EATING"... BUT AFTER FEEDING HER EIGHT FISH, CLARINE'S HANDS STOPPED. "... EH? IS, IS IT ALREADY OVER? I CAN EAT MORE YOU KNOW!?" "THIS IS YOUR FIRST TIME. WE DON'T WANT TO OVERDO IT, SO LETS STOP HERE." THE PRINCESS NODDED WITH SOME DISAPPOINTMENT. "HEY, IF I BECOME BIGGER, I'LL BE ABLE TO EAT MORE, RIGHT?" "THAT'S RIGHT. YOU'LL ALSO BE ABLE TO EAT BIGGER THINGS. FOR EXAMPLE..." WHAT DID SHE SAY AT THE END THERE? GUESSING FROM THE PRINCESS'S EXPRESSION, IT SEEMS TO BE GOOD NEWS. "YEAH, I'LL TRY MY HARDEST! I'LL MAKE THEM EVEN BIGGER AND BIGGER!"

ONE, TWO, THREE... AFTER SWALLOWING THE FOURTH FISH, A CHANGE APPEARED IN THE PRINCESS. "AH, AH, AHH~ WHA, WHAT'S THIS?" "WHAT'S WRONG, ELEINA-SAMA?" THE SIGHT OF HER BREASTS TREMBLING BECAUSE OF THE FISH STRUGGLING INSIDE WAS BOTH UNSETTLING AND BEWITCHING IN AN INDESCRIBABLE WAY. "I-IT FEELS GOOD... IT FEELS SO GOOD!!!" FROM HER OCCASIONAL MOANS, THE LIQUID DRIPPING FROM BETWEEN HER LEGS, AND HER ERECT NIPPLES, I COULD TELL THAT SHE WAS EXPERIENCING A VERY PLEASANT FEELING.



"JEEZ~ OJISAMA!! IF YOU MOVE AROUND THIS MUCH, IT'LL COME OUT RIGHT AWAY YOU KNOW?" I BECAME INCREASINGLY AROUSED AS I THRUSTED MY PENIS INTO THE PRINCESS'S BREASTS. "I'M GLAD, OJISAMA IS PLEASED WITH ME. IF OJISAMA DIDN'T LIKE GIRLS WITH BIG BREASTS... I WOULD..." IN THE MIDDLE OF SPEAKING, THE PRINCESS CHANGED THE SUBJECT. "NO, IT'S NOTHING, MORE IMPORTANTLY, THEY'RE AMAZING, RIGHT? MY BREASTS."

THAT NIGHT, I RECORDED THE THINGS I HAD SEEN TODAY INTO MY REPORT. WHILE I WAS FALLING ASLEEP, I FELT SOMETHING HEAVY ON MY ABDOMEN AND WOKE UP. WHAT WAS ON TOP OF ME WAS PRINCESS ELEINA. "GOOD EVENING, OJISAMA." THE PRINCESS STARTED TALKING WHILE TIGHTLY SQUEEZING MY PENIS! "I SAW IT DURING TODAY'S BREAST-EATING. OJISAMA WAS REALLY BULGING FROM THIS PLACE." IT WAS A SOFT SENSATION WITH AN UNBELIEVABLE AMOUNT OF PRESSURE, AND MY HIPS STARTED MOVING ON THEIR OWN.

"HEY, OJISAMA. DID IT FEEL GOOD?" WHEN I NODDED, THE PRINCESS SMILED BRIGHTLY AND SAID "EHEHE, CLARINE TAUGHT ME HOW TO DO THIS." DOES THAT MEAN THAT THAT SERVANT IS ALLOWING THIS? I CAN'T READ HER FACIAL EXPRESSION, SO I CAN'T EVER REALLY TELL WHAT SHE'S THINKING. "WELL, I'LL GET GOING NOW. OF COURSE, I'LL DO THIS FOR YOU WHENEVER YOU WANT!!! I LOVE YOU... OJISAMA!" WITH THESE PARTING WORDS, THE PRINCESS LEFT MY ROOM.

SERIOUSLY, THIS GIRL IS A PRINCESS. IF THIS SITUATION WERE TO BE SEEN, MY LIFE WOULD BE IN DANGER. HOWEVER, THIS FEELING IS WAY TOO GOOD FOR ME TO STOP. WHILE GIVING INTO TEMPTATION, I STARTED TO REACH MY LIMIT. "YOU'RE TREMBLING YOU KNOW. ARE YOU ALREADY DONE?" THE PRINCESS'S FACE STARTED TO CHANGE. INSTEAD OF AN INNOCENT GIRL, HER EXPRESSION LOOKED MORE LIKE THAT OF A HUNTER CORNERING ITS PREY. GUSH!!! GUSH!!! GUSH!!! I EJACULATED MORE THAN I EVER HAVE BEFORE, MY SEMEN OVERFLOWING FROM THE PRINCESS'S CLEAVAGE.

UNDER NORMAL CIRCUMSTANCES, THIS WOULD BE QUITE AN ABNORMAL SIZE, BUT IN PASTEAL, THERE IS A CULTURE THAT THE BIGGER THE BREASTS, THE BETTER. FOR THAT REASON, THE PRINCESS DOESN'T MIND THEIR SIZE. RATHER, SHE STILL WANTS TO ENLARGE THEM EVEN FURTHER. IS THERE AN END GOAL? "DOES OJISAMA THINK ITS BAD IF I GROW THIS MUCH? YOU DON'T, DO YOU?" WHEN I REPLIED, THE PRINCESS LOOKED DELIGHTED AND REPLIED BACK "THANK GOODNESS. I'M GOING TO BECOME MUCH BIGGER, SO PLEASE LOOK FORWARD TO IT~"



EXACTLY 100 DAYS HAVE PASSED SINCE THE FIRST MASSAGE. THANKS TO PRINCESS ELEINA ENTHUSIASTICALLY PARTICIPATING IN BREAST-EATING, HER BREASTS ARE GROWING WITH NO SIGNS OF STOPPING. CURRENTLY, HER BREASTS HAVE BECOME LARGE ENOUGH TO GO PAST HER UPPER LEGS. BASED ON THE PRINCESS'S BODY SHAPE, YOU WOULD EXPECT IT TO BE CORRESPONDINGLY QUITE HEAVY, BUT SO FAR, SHE HASN'T EXPERIENCED ANY FEELINGS OF HEAVINESS. ARE THERE SECRETS TO THOSE INSECTS OTHER THAN BREAST-EATING? "HEY HEY, OJISAMA. LOOK OVER HERE~" THE PRINCESS JOKINGLY STRUCK A POSE FOR ME.

FEENA IS PRINCESS ELEINA'S SISTER IT SEEMS. THEY'RE MORE THAN 10 YEARS APART IN AGE, SO THE LAST TIME THEY SAW EACH OTHER HER BREASTS WERE ALMOST TWICE THE SIZE OF PRINCESS ELEINA'S. SO, SHE'S GOING TO COME TO CHALLENGE PRINCESS ELEINA, HUH. WHY ON EARTH WOULD SHE DO THAT?



WHILE I WAS TALKING TO THE PRINCESS, CLARINE ENTERED THE ROOM. "TODAY WE'LL BE DOING THIS," THE THINGS CLARINE HAD BROUGHT WERE CHICKENS. "WILL IT BE OK? I WONDER, IF I EAT THOSE, WILL MY BREASTS BREAK?" SHE WAS SAYING THESE THINGS, BUT THE PRINCESS'S FACE WAS OBVIOUSLY EXCITED. I CAN TELL THAT SHE'S BECOME COMPLETELY ADDICTED TO BREAST-EATING. "IF IT'S ELEINA-SAMA, WE SHOULD HAVE THE LEEWAY. MOREOVER, I DON'T THINK IT WILL BE LONG BEFORE FEENA-SAMA COMES TO CHALLENGE YOU, SO WE'RE GOING TO INCREASE THE PACE A BIT." "T-THAT'S RIGHT, ISN'T IT. BEFORE MY SISTER COMES, I HAVE TO DO MY BEST AND DEVELOP AS MUCH AS I CAN."



WITH THE PREPARATION FINISHED, TODAY'S BREAST-EATING BEGAN. PRINCESS ELEINA'S FACE TWISTED IN PLEASURE AS SHE STARTED TO VORACIOUSLY SWALLOW THE CHICKENS. "UU!! KU!!! HYAAA!!!" "AAA♡ DELICIOUSSS♡ SO GOOOD♡" AS EXPECTED, BECAUSE THEY'RE BIGGER THAN THE FISH AND HAVE MORE VITALITY, THE FEELINGS OF PLEASURE ARE ALSO MORE INTENSE. "MORE!!! LET ME EAT MORE!!!" CLARINE ALTERNATED BETWEEN LEFT AND RIGHT AS SHE STEADILY ADDED MORE CHICKENS. "AH!!! AH!!! AH!!! HYAAN!!! MY BREASTS WILL REALLY BURST!!! EVEN THOUGH THEY'LL BURST, IT FEELS SO GOOD♡" SHE ENDED UP SWALLOWING 8 CHICKENS. THE PRINCESS'S GREATLY DISTORTED BREASTS WERE SWELLING.

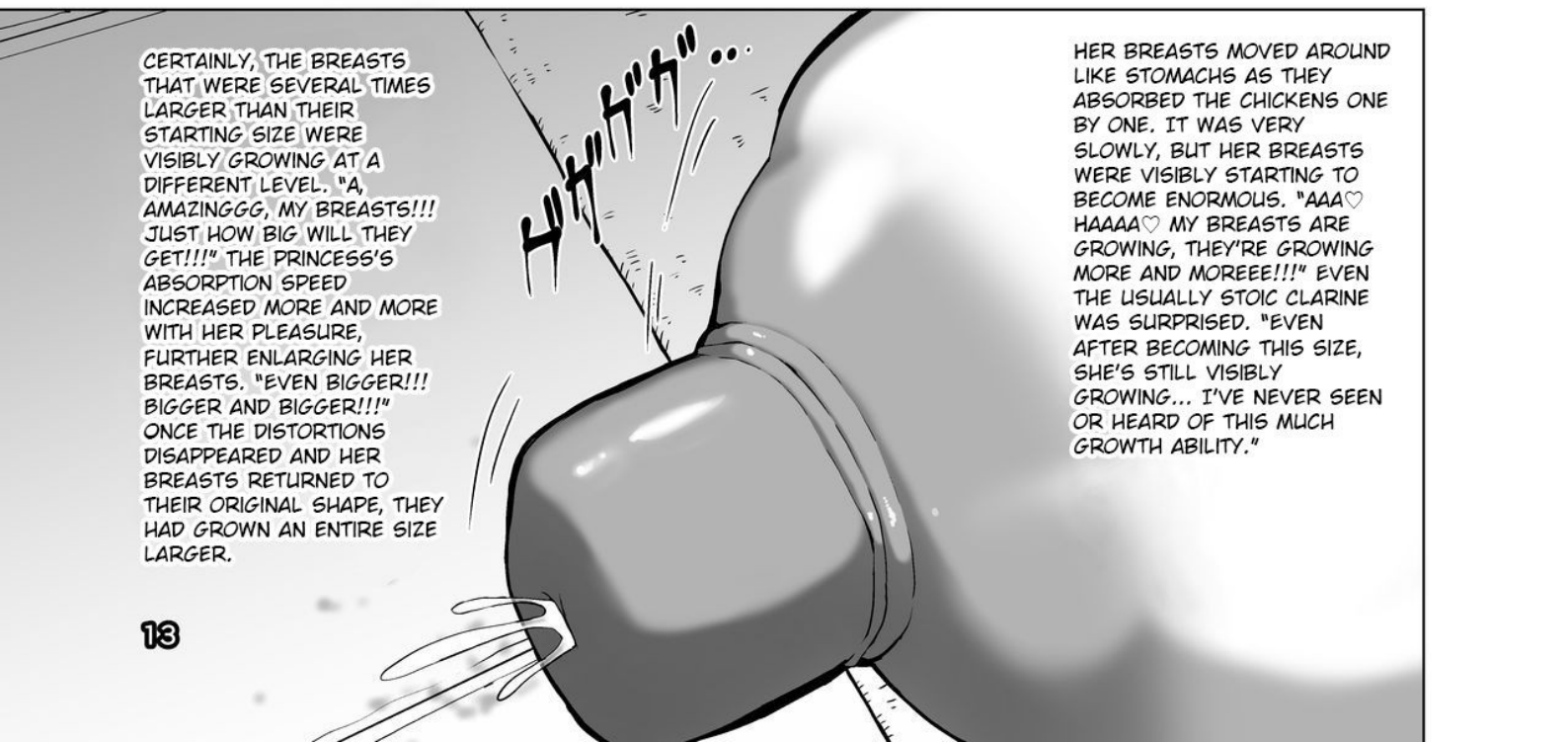

CERTAINLY, THE BREASTS THAT WERE SEVERAL TIMES LARGER THAN THEIR STARTING SIZE WERE VISIBLY GROWING AT A DIFFERENT LEVEL. "A, AMAZINGGG, MY BREASTS!!! JUST HOW BIG WILL THEY GET!!!" THE PRINCESS'S ABSORPTION SPEED INCREASED MORE AND MORE WITH HER PLEASURE, FURTHER ENLARGING HER BREASTS. "EVEN BIGGER!!! BIGGER AND BIGGER!!!" ONCE THE DISTORTIONS DISAPPEARED AND HER BREASTS RETURNED TO THEIR ORIGINAL SHAPE, THEY HAD GROWN AN ENTIRE SIZE LARGER.

HER BREASTS MOVED AROUND LIKE STOMACHS AS THEY ABSORBED THE CHICKENS ONE BY ONE. IT WAS VERY SLOWLY, BUT HER BREASTS WERE VISIBLY STARTING TO BECOME ENORMOUS. "AAA♡ HAAAA♡ MY BREASTS ARE GROWING, THEY'RE GROWING MORE AND MOREEE!!!" EVEN THE USUALLY STOIC CLARINE WAS SURPRISED. "EVEN AFTER BECOMING THIS SIZE, SHE'S STILL VISIBLY GROWING... I'VE NEVER SEEN OR HEARD OF THIS MUCH GROWTH ABILITY."

"BUT SHE ALSO SAID THAT MY SISTER WILL COME TO KILL ME BEFORE THAT HAPPENS." I SEE, SO THEY AIM TO SECRETLY ASSASSINATE PRINCESS ELEINA BEFORE SHE GROWS. "STILL, I'M NOT SCARED, BECAUSE I HAVE CLARINE AND OJISAMA. EVEN IF THEY COME TO ATTACK, WITH MY BREASTS... MY SISTER, MY MOTHER, I'LL EAT THEM ALL♡" THE PRINCESS'S EYES WEREN'T LAUGHING AS SHE SAID THAT. IN TRUTH, SHE'S KIND OF SCARY. MAYBE...

AS ALWAYS, THE PRINCESS CAME TO MY ROOM THAT NIGHT. I TRIED ASKING ABOUT THE "FEENA" THAT I HAD HEARD ABOUT THE OTHER DAY. "YEAH, AS OJISAMA SAID FEENA IS MY OLDER SISTER." PRINCESS ELEINA'S FACE BECAME GLOOMY FOR A MOMENT. "THAT'S RIGHT. ONLY A PRINCESS WITH BIG BREASTS CAN SUCCEED THE THRONE. MOREOVER, THE LOSING PRINCESS WILL BE... EATEN BY THE WINNING PRINCESS'S BREASTS." WHAT DID SHE JUST SAY? SOONER OR LATER, PRINCESS ELEINA WILL... "DON'T WORRY, OJISAMA, CLARINE SAID THAT SHE ABSOLUTELY WON'T LET THAT HAPPEN TO ME." PRINCESS ELEINA SAID WHILE LAUGHING.

"THIS PLACE... WILL GIVE YOU AN AMAZING FEELING I THINK." THE PRINCESS MADE HER NIPPLES OPEN AND CLOSE REPEATEDLY. IT LOOKED JUST LIKE A KOI FISH HOPING FOR FOOD. "HUH? COULD IT BE THAT YOU'RE WORRIED? ITS OK. I WOULD NEVER EAT MY BELOVED OJISAMA♡" AFTER SAYING THAT, THE PRINCESS STARTED TO TAKE IN MY PENIS WITH HER NIPPLE.

AFTER PICKING UP ON THE MOOD, PRINCESS ELEINA STARTED TALKING. "HEY HEY, OJISAMA, DO YOU WANT TO TRY USING THIS PLACE TODAY?" ONCE THE PRINCESS TOOK OFF THE BAND SUPPORTING HER BREASTS, HER NIPPLES WHICH HAD GROWN TO AN INCOMPARABLE DEGREE STARTED TWITCHING.



うんうん

"FUFUFU♡ OJISAMA'S CUM IS DELICIOUS♡ I WANT MORE♡" MY PENIS WAS FORCIBLY MADE ERECT OVER AND OVER AGAIN AS MY SEMEN WAS SQUEEZED OUT.

HER NIPPLE REPEATEDLY CONTRACTED BACK AND FORTH WHILE FRANTICALLY SUCKING IN AN ATTEMPT TO SWALLOW ME. I COULDN'T HELP BUT COME TO THAT UNBELIEVABLE SENSATION.

じゅ...
じゅ...

THE PRINCESS'S NIPPLE THAT HAD GROWN TO BE THICKER THAN MY THIGHS ENGLTFED MY PENIS WITH A SLURPING NOISE. "JEEZ OJISAMA, YOU'RE TREMBLING SO MUCH♡ BUT WE'RE ONLY JUST GETTING STARTED YOU KNOW♡"

じゅ...

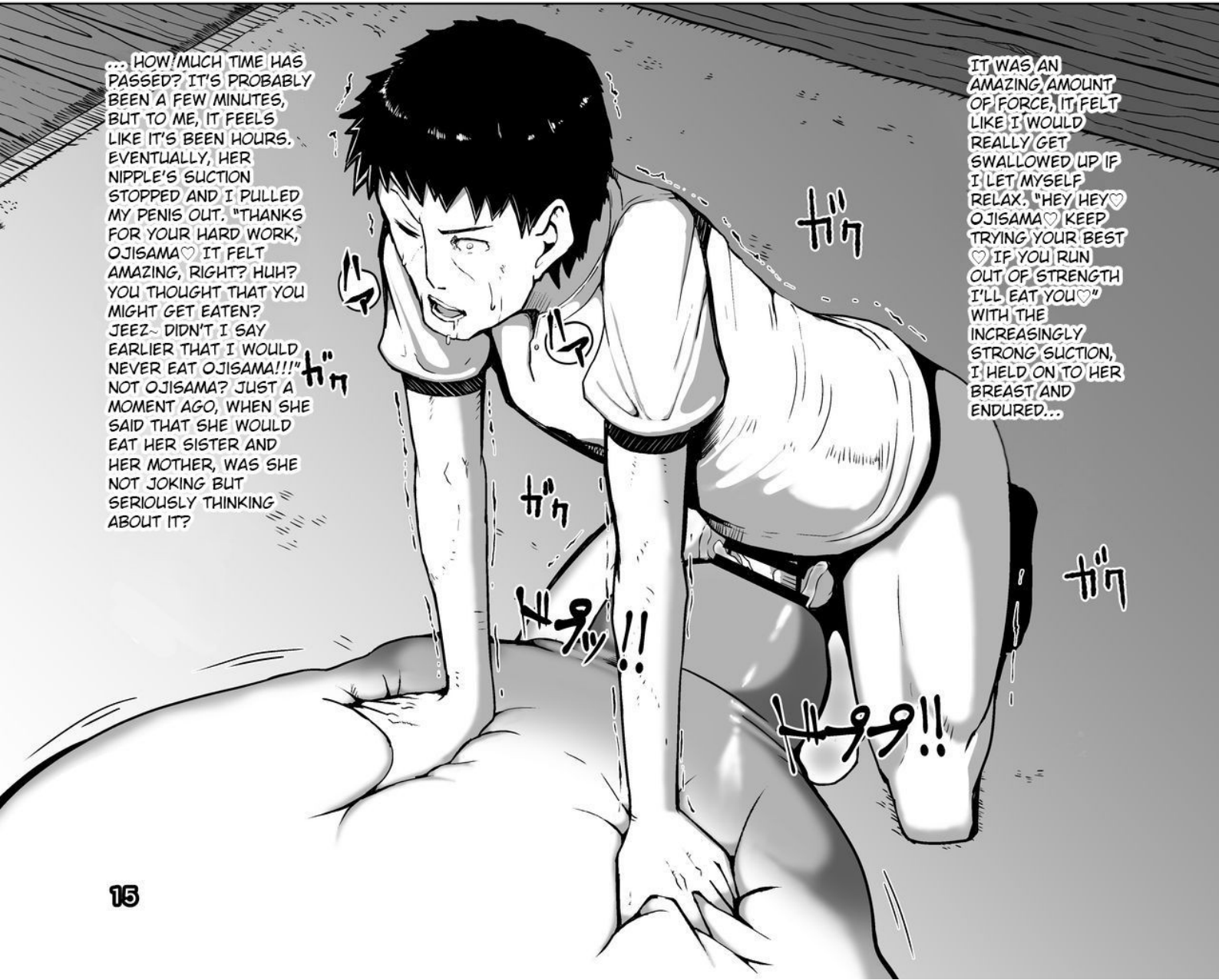

... HOW MUCH TIME HAS PASSED? IT'S PROBABLY BEEN A FEW MINUTES, BUT TO ME, IT FEELS LIKE IT'S BEEN HOURS. EVENTUALLY, HER NIPPLE'S SUCTION STOPPED AND I PULLED MY PENIS OUT. "THANKS FOR YOUR HARD WORK, OJISAMA♡ IT FELT AMAZING, RIGHT? HUH? YOU THOUGHT THAT YOU MIGHT GET EATEN? JEEZ~ DIDN'T I SAY EARLIER THAT I WOULD NEVER EAT OJISAMA!!!" NOT OJISAMA? JUST A MOMENT AGO, WHEN SHE SAID THAT SHE WOULD EAT HER SISTER AND HER MOTHER, WAS SHE NOT JOKING BUT SERIOUSLY THINKING ABOUT IT?

じゅ

じゅ

じゅ!!

じゅ

IT WAS AN AMAZING AMOUNT OF FORCE, IT FELT LIKE I WOULD REALLY GET SWALLOWED UP IF I LET MYSELF RELAX. "HEY, HEY♡ OJISAMA♡ KEEP TRYING YOUR BEST♡ IF YOU RUN OUT OF STRENGTH I'LL EAT YOU♡" WITH THE INCREASINGLY STRONG SUCTION, I HELD ON TO HER BREAST AND ENDURED...

じゅ

じゅ!!

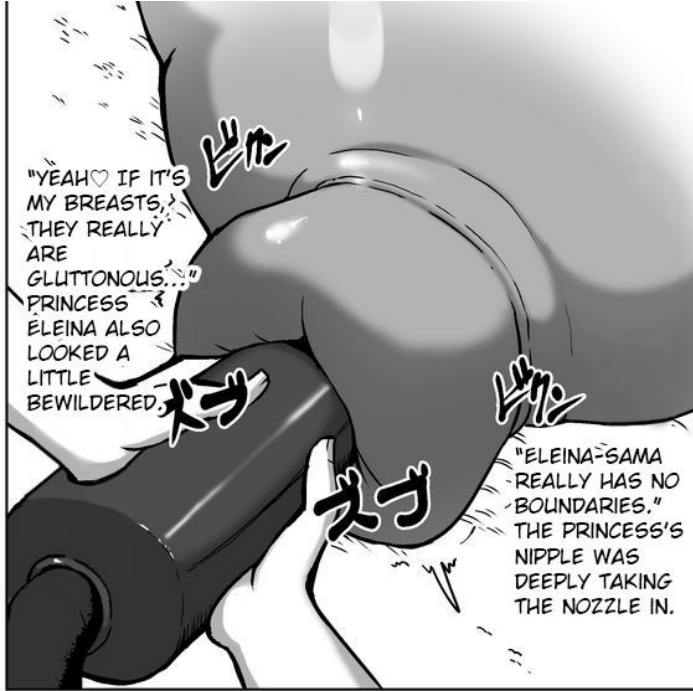

"YEAH♥ IF IT'S MY BREASTS, THEY REALLY ARE GLUTTONOUS..." PRINCESS ELEINA ALSO LOOKED A LITTLE BEWILDERED.

"ELEINA-SAMA REALLY HAS NO BOUNDARIES." THE PRINCESS'S NIPPLE WAS DEEPLY TAKING THE NOZZLE IN.



CLARINE TOOK THE NOZZLE OF THE PUMP SHE HAD BROUGHT OVER TO HER NIPPLE...

IT'S BEEN ONE WEEK SINCE PRINCESS ELEINA DID BREAST-EATING WITH CHICKENS. "IF THEY'RE THIS BIG, IT SHOULD BE ENOUGH." IT SEEMS LIKE THERE'S GOING TO BE A NEW TRIAL TODAY.

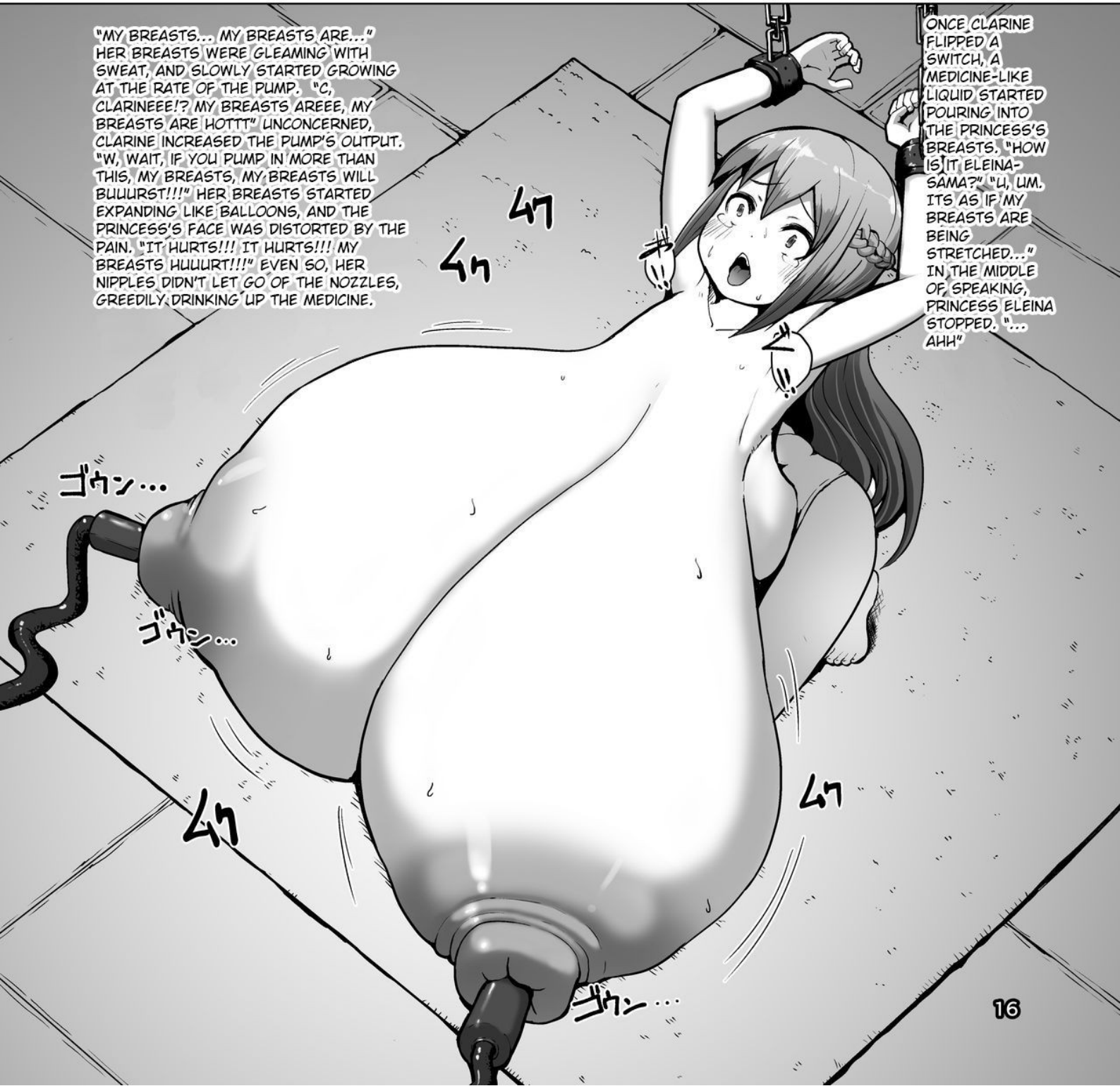

"MY BREASTS... MY BREASTS ARE..." HER BREASTS WERE GLEAMING WITH SWEAT, AND SLOWLY STARTED GROWING AT THE RATE OF THE PUMP. "C, CLARINEEEE!? MY BREASTS AREEE, MY BREASTS ARE HOTTT" UNCONCERNED, CLARINE INCREASED THE PUMP'S OUTPUT. "W, WAIT, IF YOU PUMP IN MORE THAN THIS, MY BREASTS, MY BREASTS WILL BUURST!!!" HER BREASTS STARTED EXPANDING LIKE BALLOONS, AND THE PRINCESS'S FACE WAS DISTORTED BY THE PAIN. "IT HURTS!!! IT HURTS!!! MY BREASTS HUUURT!!!" EVEN SO, HER NIPPLES DIDN'T LET GO OF THE NOZZLES, GREEDILY DRINKING UP THE MEDICINE.

ONCE CLARINE FLIPPED A SWITCH, A MEDICINE-LIKE LIQUID STARTED POURING INTO THE PRINCESS'S BREASTS. "HOW IS IT ELEINA-SAMA?" "U, UM, ITS AS IF MY BREASTS ARE BEING STRETCHED..." IN THE MIDDLE OF SPEAKING, PRINCESS ELEINA STOPPED. "... AHH"



"AH, UUU... THAT WAS SO CRUEL, CLARINE." "MY DEEPEST APOLOGIES. HOWEVER, ELEINA-SAMA... WITH THE MATTERS OF FEENA-SAMA IN MIND, EXPANSION IS A NECESSITY..." PRINCESS ELEINA RELUCTANTLY AGREED. "MOREOVER, IF THEY EXPAND THIS MUCH, YOU WILL BE SAFE NO MATTER WHEN FEENA-SAMA COMES." "EHEHE, IT MEANS I CAN TURN THE TABLES ON HER RIGHT? ♡" PRINCESS ELEINA LOOKED AT HER OWN BREASTS WITH AN EXPRESSION OF ECSTASY. ACCORDING TO CLARINE, THAT MEDICINE WAS ONE THAT INCREASES THE AMOUNT THAT THE NIPPLES AND BREASTS CAN BE STRETCHED, BUT DOESN'T CAUSE PERMANENT GROWTH. AT ANY RATE, "TURNING THE TABLES" IS... AFTER ALL...

A GROANING SOUND CAME FROM PRINCESS ELEINA'S BREASTS THAT WERE FILLING TO THE POINT OF BURSTING. "HAA... HAA... I CAN'T KEEP GOINGGG!!! MY BREASTS WILL REALLY BUURST!!!" HAVE THEY DOUBLED IN SIZE? CLARINE STOPPED THE PUMP. "EXPANDING TO THIS EXTENT IS... AS EXPECTED OF ELEINA-SAMA."

"AN ASSASSIN, HUH. AMONG OUR COUNTRY, YOUR SKILLS ARE TOP CLASS. WITHOUT A DOUBT, YOU WERE SENT HERE BY FEENA-SAMA." A TOP CLASS ASSASSIN? DID CLARINE DEFEAT HIM? "AH, OJISAMA!! CLARINE PROTECTED ME." THE PRINCESS WAS SURPRISINGLY ENERGETIC. "I EXPECT THAT FEENA-SAMA IS NEARBY. THE OPPOSING SIDE IS ALSO AIMING FOR ELEINA-SAMA'S BREASTS AFTER ALL." JUST NOW, CLARINE SAID "ALSO" WHEN TALKING ABOUT THE OPPOSING SIDE. NOW I'M CONVINCED. PRINCESS ELEINA MUST ALSO BE PLANNING TO EAT PRINCESS FEENA. EVEN IF SHE APPEARS INNOCENT, THIS IS WHAT IT MEANS TO BE A PERSON OF ROYALTY...



ITS BEEN 3 DAYS SINCE PRINCESS ELEINA'S BREAST EXPANSION WAS PERFORMED. AS USUAL, WE HEADED TOWARDS THE BASEMENT TODAY, BUT THE SITUATION WAS DIFFERENT THAN USUAL. "IT APPEARS THAT FEENA-SAMA IS COMING TONIGHT. YOU MUST REMAIN HIDDEN ALL DAY TODAY." THAT'S WHAT I WAS TOLD, SO I'M NOW HIDING IN A SPACE ABOVE THE CEILING. HOW MUCH TIME HAS PASSED? FROM THE FLOOR BELOW THERE WAS A LOUD NOISE, AND EVEN THOUGH I WAS TOLD TO REMAIN HIDDEN, I WAS WORRIED. AFTER COMING DOWN, PRINCESS ELEINA AND CLARINE WERE THERE, ALONG WITH AN UNFAMILIAR, BOUND UP MAN.

"IT WON'T BE AN ISSUE. ELEINA-SAMA'S AUGMENTABILITY WAS CONFIRMED JUST THE OTHER DAY." "YEAH, I KNOW. MORE IMPORTANTLY, CAN WE GET STARTED SOON? MY BREASTS ARE ALREADY THROBBING..." PRINCESS ELEINA WAS STRANGELY EXCITED. "FUFUFU, IF THEY'RE IN THAT STATE, THEN THERE'S REALLY NO ISSUES."



"HMPH, I'M STILL BIGGER, AREN'T I, WILL YOU REALLY BE ABLE TO SWALLOW ME?" DESPITE BEING RESTRAINED, PRINCESS FEENA WAS STILL VERY SELF-ASSURED. IT'S PROBABLY BECAUSE, IF YOU THINK ABOUT IT NORMALLY, THERE'S NO WAY THAT YOU CAN BE EATEN BY SOMETHING SMALLER THAN YOU.



ITS ONLY BEEN 10 MINUTES SINCE CLARINE LEFT. "IT WAS AS I EXPECTED." CLARINE BROUGHT WITH HER TWO PEOPLE DRESSED IN ALL BLACK. ON ONE SIDE, THERE WAS A WOMAN WHOSE ROLE I ASSUME WAS TO BOTH ACT AS A GUARD AND CARRY BREASTS, AND THE OTHER PERSON WAS SOMEONE WITH BREASTS THAT RIVALED PRINCESS ELEINA, PRINCESS FEENA.

IT SEEMS LIKE THE TWO ASSASSINS INSIDE ARE PUTTING UP THEIR LAST RESISTANCE. THE PRINCESS'S BREASTS RUMBLLED AS THEY CHANGED INTO A DISTORTED SHAPE. "HA, HII♥ HARDER♥ STRUGGLE HARDERRR♥♥♥" "AS EXPECTED OF ELEINA-SAMA. WITH THIS, EVEN SWALLOWING FEENA-SAMA WON'T BE AN ISSUE." CLARINE GRABBED THE LAST PERSON, PRINCESS FEENA, AND BROUGHT HER TO THE RIGHT NIPPLE.

AT LAST, THE TWO ASSASSINS WERE ENTIRELY SWALLOWED UP BY HER BREAST. "THIS IS THE EFFECT OF THE OTHER DAY'S TRAINING, ELEINA-SAMA." THE BREAST THAT HAD SWALLOWED UP TWO PEOPLE SWELLED TO NEARLY TWICE ITS PREVIOUS SIZE.

PRINCESS FEENA FINALLY BECAME FLUSTERED WHEN CLARINE GAVE NO RESPONSE. "PLEASE! FORGIVE ME! I APOLOGIZE FOR EVERYTHING I'VE DONE UNTIL NOW!!!" PRINCESS ELEINA'S NIPPLE WAS GETTING MORE AND MORE ERECT IN ANTICIPATION. "NO, NOOO!!! I DON'T WANT TO BE EATEN!!!" "S, SHIT!!! IT WAS SUPPOSED TO BE ME!!! I WAS SUPPOSED TO EAT Y-" WITH A WET SOUND, PRINCESS FEENA'S HEAD WAS BEING SWALLOWED.

"M, MY BREASTS ARE BIGGER. THERE'S NO WAY THAT SHE CAN EAT ME." AFTER WITNESSING FIRST HAND PRINCESS ELEINA'S ASTOUNDING EXPANSION RATE, PRINCESS FEENA, WHO WAS CONFIDENT UP UNTIL NOW, WAS VISIBLY SHAKING. CLARINE, WITH AN UNCHANGING EXPRESSION, SLOWLY BROUGHT PRINCESS FEENA'S HEAD TOWARDS THE NIPPLE. "I, I GET IT. I'LL DOUBLE YOUR PAY. COME TO MY SIDE, CLARINE."

PROPORTIONALLY TO THE SIZE, IT SEEMS TO BE AN AMAZING FEELING. PRINCESS ELEINA'S NIPPLE EXCEEDED ITS LIMIT AS IT ENLARGED. "AAAAAA♥♥ MY SISTER'S HUGE BREASTS ARE COMING INTO MINEEE♥♥"

ズリユ...

ズリユ...ズリユ...

PRINCESS ELEINA'S ERECT NIPPLE STARTED TO WIDEN EVEN FURTHER AS SHE STARTED TO ENGLUF PRINCESS FEENA WITH HER BREAST. "KUFUU!! S, SO TIGHT!!! I WANT TO EAT!!! I WANT TO EAT HERRR!!! I'LL EAT MY SISTER, AND MY MONSTER TITS WILL GET EVEN MORE ENORMOUSSS♥"

ハァ

ハァ

ハァ

"IT WENT IN♥ IT, ALL WENT INTO MY BREASTS♥" FINALLY, PRINCESS FEENA'S WHOLE BODY WAS SWALLOWED. I HAVE THE FEELING THAT THE REMAINING BREASTS ALSO BE SWALLOWED BEFORE LONG.

グン...

グン...

SLOWLY BUT SURELY... HER ARMS AND THEN HER CHEST WERE GRADUALLY PULLED IN. PRINCESS FEENA, NOT WANTING TO BE SWALLOWED, WAS DESPERATELY FLAILING HER LEGS AROUND, BUT IT SEEMS LIKE IT'S ONLY A MATTER OF TIME UNTIL HER WHOLE BODY IS SWALLOWED.

ガン!!

ガン!!

ガン!!

ボゴン!!

ヒン!!

ヒン!!

IT APPEARS THAT THE ABSORPTION HAS BEGUN. THE CONVULSIONS WERE GETTING SMALLER AND SMALLER, AND JUST LIKE THAT, THE DISTORTED BREASTS RAPIDLY STARTED RETURNING TO THEIR ORIGINAL SHAPE.

THE BREASTS THAT HAD SWALLOWED 3 PEOPLE WERE DISTORTING AS THEY SWELLED TO A SIZE THAT SEEMED LIKE THEY MIGHT BURST. THE WAY THEY CONVULSED WAS AS IF THEY WERE LIVING THINGS. "AAAAAAAH♥ ITS FLOODING INTO MY BREASTSSS♥"

ヒン!!

ボゴン!!

ヒン!!

OVERWHELMED WITH PLEASURE, THE PRINCESS STARTED SCREAMING WITH A STRANGE VOICE. "OOOH-OOOOH AAAAAAAAAAAAAAH!!!" "IT, IT FEELSH SHO GOOOOOOD♥♥" "MY BOOBSSH ARE GOING CRAZZYYYY!!!"

"AH♥ AH♥ IT STARTED♥ A, AMAZING, I, I'M COMINGGG!!!" SHE TOOK IN PRINCESS FEENA'S BREASTS, AND HER BREASTS STARTED GROWING AT AN UNPRECEDENTED RATE.

ヒン!!



"S, STOPPPP!!!
THEY'LL
BURSTTTT!!!"
THE PRINCESS'S
BREASTS MADE
SOUNDS LIKE
THEY WERE
FILLED TO THE
BRIM.

"I CAN'T!!! I'LL
DIEE, I'LL
DIEEE!!!" THE
PRINCESS'S
FACE WAS
TWISTED BY THAT
EXCESSIVELY
PLEASURABLE
FEELING. EVEN
STILL, HER
GROWTH WAS
ACCELERATING
MORE AND MORE.

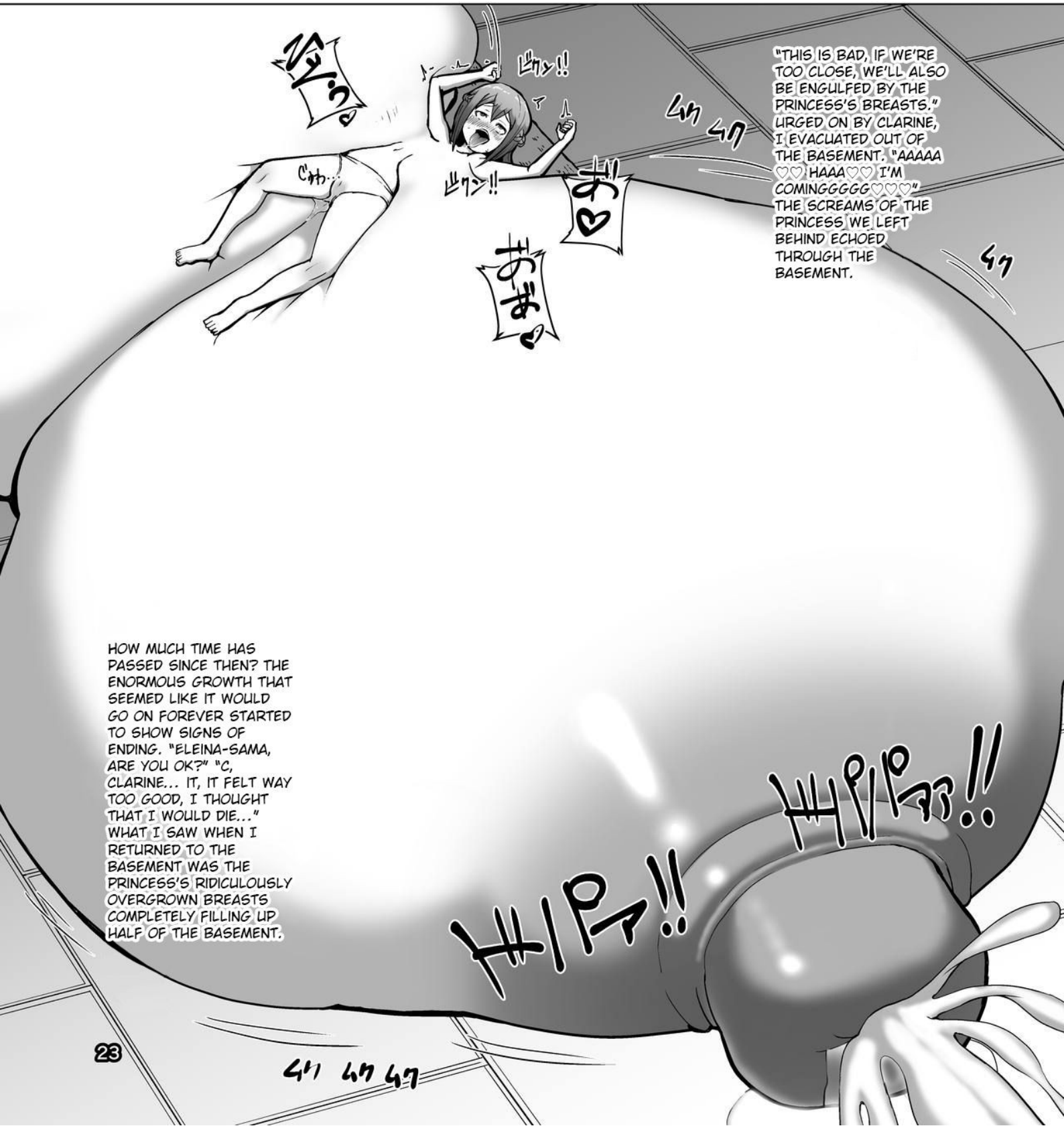

"THIS IS BAD, IF WE'RE
TOO CLOSE, WE'LL ALSO
BE ENGLTFED BY THE
PRINCESS'S BREASTS."
URGED ON BY CLARINE,
I EVACUATED OUT OF
THE BASEMENT. "AAAAA
♡♡ HAAA♡♡ I'M
COMINGGGGGG♡♡♡"
THE SCREAMS OF THE
PRINCESS WE LEFT
BEHIND ECHOED
THROUGH THE
BASEMENT.

HOW MUCH TIME HAS
PASSED SINCE THEN? THE
ENORMOUS GROWTH THAT
SEEMED LIKE IT WOULD
GO ON FOREVER STARTED
TO SHOW SIGNS OF
ENDING. "ELEINA-SAMA,
ARE YOU OK?" "C,
CLARINE... IT, IT FELT WAY
TOO GOOD, I THOUGHT
THAT I WOULD DIE..."
WHAT I SAW WHEN I
RETURNED TO THE
BASEMENT WAS THE
PRINCESS'S RIDICULOUSLY
OVERGROWN BREASTS
COMPLETELY FILLING UP
HALF OF THE BASEMENT.





"COME ON♡ OJISAMA♡ KEEP DOING YOUR BEST!!!" EACH TIME I THRUSTED MY HIPS, AN INSANE AMOUNT OF MILK OVERFLOWED FROM HER NIPPLES. "IF YOU DON'T DO YOUR BEST, I'LL EAT YOU♡" THREATENED BY THE PRINCESS, I WAS SQUEEZED TO MY ABSOLUTE LIMIT. "FUFUFU, SUCH A GOOD FEELING♡" "ELEINA-SAMA, I'VE BROUGHT TODAY'S MEAL."

AFTER THAT, PRINCESS ELEINA WENT ON TO EAT THE QUEEN AND ACHIEVE EVEN GREATER GROWTH. THE PRINCESS OBTAINED A SIZE THAT WAS AT THE TOP LEVEL EVEN AMONG THE LONG ANNALS OF HISTORY. SHE WAS CALLED THE SECOND COMING OF THE GODDESS, AND ATTAINED THE GREATEST POLITICAL POWER IN THE COUNTRY. AND I, IN ACCORDANCE WITH THE PRINCESS'S WISHES, HAVE STAYED IN THIS COUNTRY, AND AM LIVING WITH HER EVEN NOW.





CLARINE BROUGHT IN
A COW FOR THE
PURPOSE OF
BREAST-EATING.
"TODAY THERE'S A
CUTE COW, HUH♡
LUFUFLU, IT LOOKS
TASTYY♡" EVEN AT
THIS SIZE, THE
PRINCESS'S APPETITE
KNOWS NO END.
JUST HOW BIG WILL
THEY GET? IT
SEEMS THAT
PRINCESS'S
BREAST-EATING WILL
CONTINUE FOR QUITE
SOME TIME.

あとがき

前回のコミケに続き今回のコミケもニプルボア本です。
最初の予定ではニプルボアはなく、膨乳のみだったのですが途中で物足りなくなってしまう予定を変更してニプルボア本にしました。

必要な情報ではなかったので本文中特に描きませんでした。がクラリーネは女神の仮の姿であり人間ではありません。しかもふたなりでエレナ王女のお父様です。エレナ王女はそれを知らない訳ですが神様の子供ですので王女もまた人間じゃない…という設定だったりします。このまま成長を続ければ本当に乳神様になっちゃいますね。

こういう設定を考えるのが好きで子どものころからいろいろ考えてゲーム作ったりしてたんですがいつも発想が空回りしたうえ画力や表現力が足りず挫折するタイプでした。今でもRPG作るたびに挫折してるのであんまり変わってないとも言えますが…

前回に続いて読んでいただいた方、ありがとうございます！
今回初めてニプルボア本にふれた方、これからもよろしくお願いします。
乳神 選蟲編と覚醒編もよろしくね！
次回のイベント参加予定は11月にあるふたけっです。
cock vore本を予定してます。
ではまた、次の本で。

むら

犬帝国

奥付
誌名 乳神 辺境の王女編
発行 犬帝国
発行者 むら
発行日 2017.8.13
印刷所 プリントウォーク様
連絡先 mousoucata@gmail.com
twitter inuteikoku
pixiv 492957